

Overview

The **2-Port SmartNode** is a flexible network I/O device that is easily customized with a wide variety of interface types such as DMX, Digital I/O, Relays, Serial, Station Bus, MIDI, and more, using optional **Smart Modules**. By adding modules, the physical interfaces become available on the network, and can be configured to augment a CueServer system or freely convert between popular network protocols such as sACN, Art-Net, KiNET, and more.

For example, a SmartNode with DMX modules can convert between sACN, Art-Net, and physical DMX. Additionally, multiple modules can be merged together, or used to create splitters or repeaters. Other Smart Modules, such as Relays, Digital I/O, Station Bus, MIDI, etc., can also be used with a variety of popular network protocols.

Use the **2-Port SmartNode** to add additional I/O to a lighting or custom automation project over the network. With its vast array of configuration options, the SmartNode is easily integrated into both CueServer-based systems and general lighting control projects.

Features

- Self-contained network I/O chassis for hosting up to two Smart Modules
- May be powered via PoE or 12-24V DC Input
- Multiple protocol conversion between CueServer, sACN, Art-Net, KiNET, CueStation, and UDP
- Allows for source merging or fallback scenarios, multiple destinations, and local loopback between modules
- Supports the growing family of Smart Modules
- Small anodized aluminum enclosure with optional brackets for panel, DIN, or truss mounting
- Smart Modules are sold separately

Applications

- Commercial or Residential
- Architectural or Entertainment Lighting
- Themed Entertainment Venues
- Cruise Ships
- Museums
- Broadcast Studios
- Water Fountains
- Trade Shows
- Building Management



SN-200
2-Port SmartNode

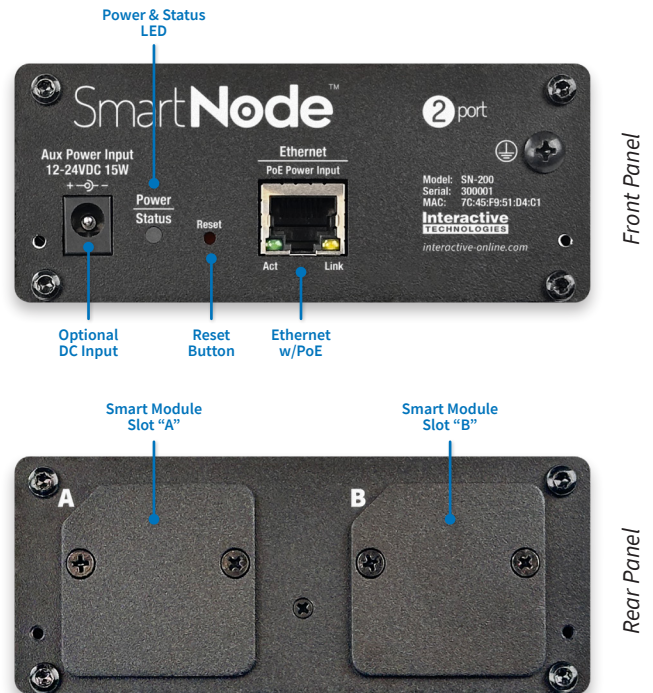

Optional Smart Modules

- Available separately:
More than a dozen available modules covering DMX-512, Digital-Analog I/O, Relays, MIDI, Serial, Station Bus, and more.



Interactive Technologies, Inc.

5295 Lake Pointe Center Drive
Cumming, GA 30041 USA
1-678-455-9019
interactive-online.com

Catalog #:

Prepared by:





Project:

Date:

Specifications

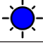
Feature	Detail	Description
Capacity	Smart Module Slots	2
	Endpoints per Slot	4
Protocols	Ethernet	CueServer, sACN, Art-Net, KINET v1/v2, CueStation, UDP
	Module	DMX-512, Station Bus, Digital I/O, Relay, Serial, MIDI
Connections	Power (optional)	2.1mm DC Power Input Jack
	Network	RJ45 10/100 Base-T Ethernet
Configuration	Software	Interactive Studio
Power	DC Input	12-24VDC, 0.5 Watts + Modules
	Power-over-Ethernet	Type 1, Class 0, 1.5 Watts + Modules
Compliance	Standards	Pending
Physical	Width	4.27" (109 mm) without mounting brackets 4.81" (122 mm) with vertical mounting bracket 5.13" (130 mm) with vertical DIN mounting bracket 6.15" (156 mm) with horizontal mounting brackets
	Length	3.43" (87 mm) + Connector/Cable Requirements
	Height	1.77" (45 mm)
	Weight	0.51 lbs. (0.23 kg)
Environmental	Operating Temperature	-13° to 158° F (-25° to 70° C)
	Storage Temperature	-40° to 176° F (-40° to 80°C)
	Humidity	5 to 95%, non-condensing
	Altitude	10,000 feet maximum

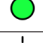
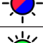
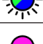
Power/Status LED

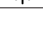
	Starting Up (~2 seconds)
	On (using DC Power)
	On (using PoE Power)
	Device Identify Mode
	Reset Button Held at Startup
	Factory Reset Confirmed
	Firmware Update in Progress
	Internal Error

○ = Solid,  = Slow Flashing,  = Fast Flashing

* For information about the LED indicator on individual modules, please refer to the specific Smart Module data sheets.

Ordering

SmartNode

SN-200

2-Port SmartNode

Includes 2-Port SmartNode with two empty module slots. Smart Modules not included, order separately. Power Supply not included, use PoE or order DC Power Supply separately.

Smart Modules

SM-_____

Smart Module

Smart Modules (SKU starts with SM-) are ordered separately. See web site for available modules.

Optional DC Power Supply

Not needed if using Power-over-Ethernet.

AC-24-AUST

24VDC Global Power Supply w/Australian Clip

AC-24-EURO

24VDC Global Power Supply w/European Clip

AC-24-UK

24VDC Global Power Supply w/UK Clip

AC-24-US

24VDC Global Power Supply w/US Clip

Optional Mounting Bracket Kits

AX-BR-HMK

Horizontal Mounting Kit

AX-BR-HDK

Horizontal DIN Rail Kit

AX-BR-VMK

Vertical Mounting Kit

AX-BR-VDK

Vertical DIN Rail Kit

Software

Interactive Studio

Programming software for both MacOS and Windows may be downloaded for free from interactive-online.com.



SmartNode is proudly designed, engineered, and manufactured in the USA.